

# Horton & Storey



Hampton Lane, Catherine-De-Barnes,  
Solihull

Asking Price of **£365,000**

# Property Features

---

- Immaculately presented
- Three double bedrooms
- Great transport links
- Semi-rural location
- Separate garage
- Parking for two cars
- Downstairs w.c.
- En-suite to master bedroom

## Full Description

---

### LOCAL AREA

The property is well located for Solihull town centre, Birmingham International airport and railway station. It benefits from a village environment boasting a local Post office, restaurant and village public house.

### APPROACH

The property is accessed via a laid to lawn front garden and a paved footpath leading to;

### CANOPY PORCH

Front door with access leading into;

### ENTRANCE HALLWAY

With decorative coving to ceiling, wall mounted central heating radiator, stairs to floor accommodation, storage cupboard and doors leading to kitchen and;

### GUEST CLOAKROOM

Suite comprises of; low level w.c., pedestal wash basin, central heating radiator, obscure double glazed window to the front elevation.

### KITCHEN 10' 0" x 8' 5" (3.05m x 2.59m)

The kitchen is located at the front of the property. The kitchen comprises of a mixture of wall and based units with an inset stainless steel sink unit with drainer, fitted appliances including a four ring induction hob with extractor hood over, integrated dishwasher, plumbing for a washing machine, integrated larder fridge/freezer, wall mounted Valliant gas central heating boiler and double glazed window to the front elevation.



**LOUNGE/DINING ROOM 16'8" x 15' 9" (5.10m x 4.82m)**

The lounge/dining room has a wall mounted gas fire, double glazed windows to the rear elevation and well-appointed double glazed french doors leading to the rear garden. Wall mounted central heating radiator.

**FIRST FLOOR LANDING**

Doors to bedrooms two and three and Jack and Jill style bathroom, stairs to the second floor accommodation, wall mounted central heating radiator and a storage cupboard.

**BEDROOM TWO (FRONT) 13'10" x 8'6" (4.23m x 2.60m)**

Built-in double wardrobe, wall mounted central heating radiator and door leading into a Jack and Jill style bathroom. Double glazed window to the front elevation.

**BEDROOM THREE (REAR) 13' 1" x 8' 3" (4.81m x 2.53m)**

Double glazed windows to the rear elevation and wall mounted central heating radiators.

**FAMILY BATHROOM (JACK AND JILL STYLE)**

Suite comprises of; a panelled bath with electric power shower over, pedestal sink with low level w.c., wall mounted central heating radiator and obscure glazed window to the front elevation.

**SECOND FLOOR**

**MASTER BEDROOM 14' 2" x 10' 4" (4.34m x 3.17m)**

Double glazed window to the front elevation, wall mounted central heating radiator, built in double wardrobe and door into;

**EN SUITE SHOWER ROOM**

Suite comprises of; shower cubicle with power shower, pedestal sink, low level w.c., wall mounted central heating radiator and double glazed Velux roof window to rear elevation.



## OUTSIDE

### PRIVATE REAR GARDEN

Having a large decked area, Laid to lawn and rear access into the garage.

### OFF ROAD PARKING

There is off road parking to the rear of the property for two cars.

### SINGLE GARAGE 19' 4" x 9' 8" (5.90m x 2.95m)

Having a remote controlled up and over door, courtesy door out to the rear garden and power points.

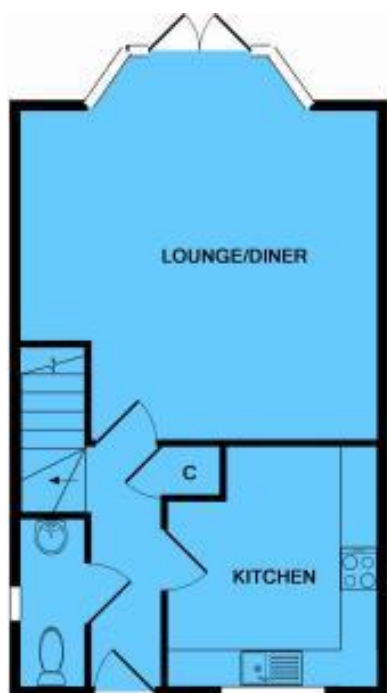

GROUND FLOOR



1ST FLOOR



2ND FLOOR

Whilst every attempt has been made to ensure the accuracy of the floor plan contained here, measurements of doors, windows, rooms and any other items are approximate and no responsibility is taken for any error, omission, or mis-statement. This plan is for illustrative purposes only and should be used as such by any prospective purchaser. The services, systems and appliances shown have not been tested and no guarantee as to their operability or efficiency can be given.  
Made with Metropix Q2015.

Agents Note: Whilst every care has been taken to prepare these sales particulars, they are for guidance purposes only. All measurements are approximate are for general guidance purposes only and whilst every care has been taken to ensure their accuracy, they should not be relied upon and potential buyers are advised to recheck the measurements.

179 Stratford Road, Shirley, Solihull, West Midlands,  
B90 3AU

[www.hortonstorey.com](http://www.hortonstorey.com)  
[sales@hortonstorey.com](mailto:sales@hortonstorey.com)  
01216630099